

# How to setup Eduroam Wireless on your Android Device

1) Click on **Play Store**

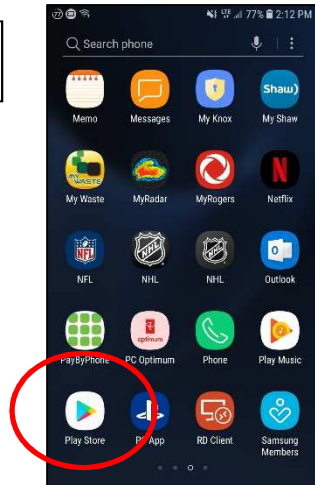

2) In the search field type **EDUROAM CAT** then click search bottom right. From the list, click on **EDUROAM CAT**

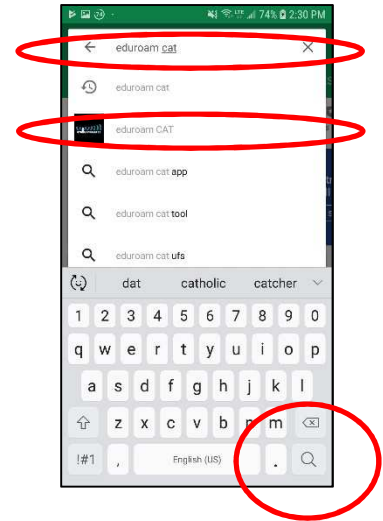

3) Click on **Install, Accept** and **Open** when prompted

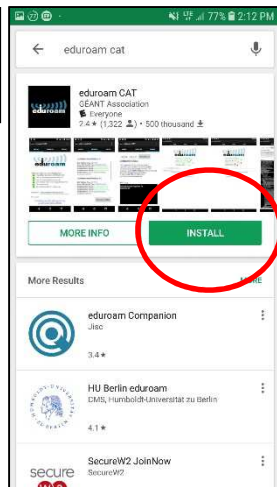

4) Under **Nearby Configs**, wait for the University of Winnipeg logo to appear, click on it

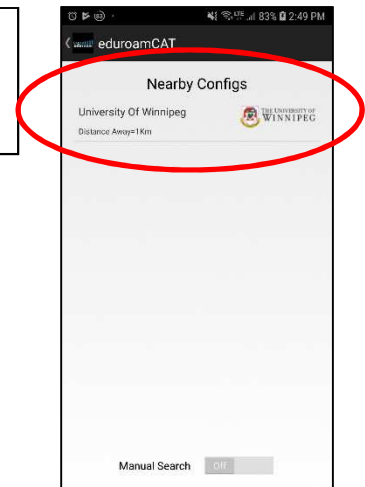

5) Click on **Install**

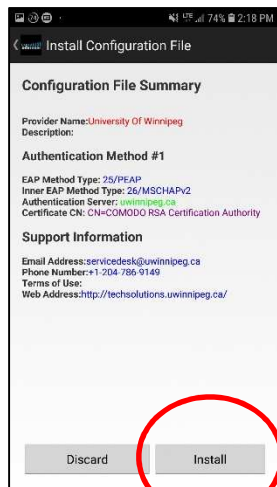

6) Click on **Yes** to install the profile.

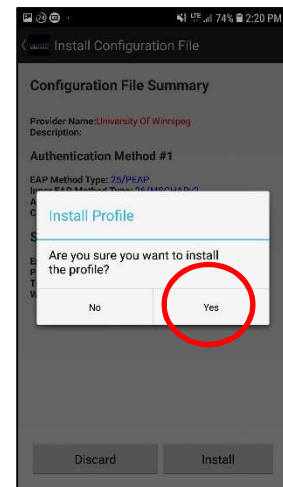

7) Enter **YOUR UW email address and Network Password, this is not your email password. Use the password you use to login to your computer.**

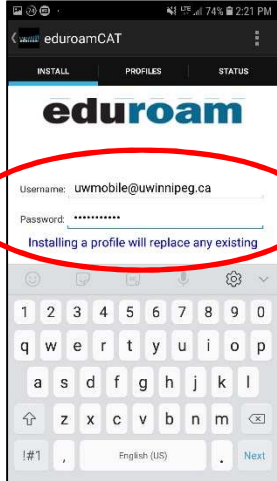

8) Click **Install**, you may need to slide up to see it as it may be hidden by the keyboard

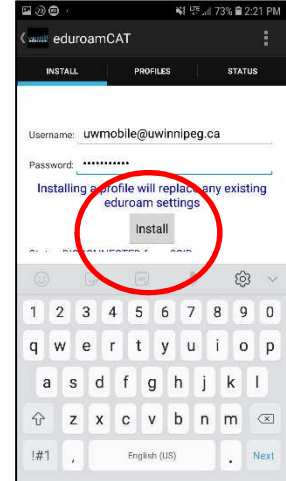

9) **Profile Installed** will display at the bottom.



10) **Exit Eduroam CAT**  
**Check to see if you are connected to Eduroam**

